

Silbury Road

ASHTON VALE

APPROXIMATE FLOOR AREA
76.9 SQM / 827 SQFT



GARAGE
0 sq.ft. (0.0 sq.m.) approx.



GROUND FLOOR
480 sq.ft. (44.6 sq.m.) approx.

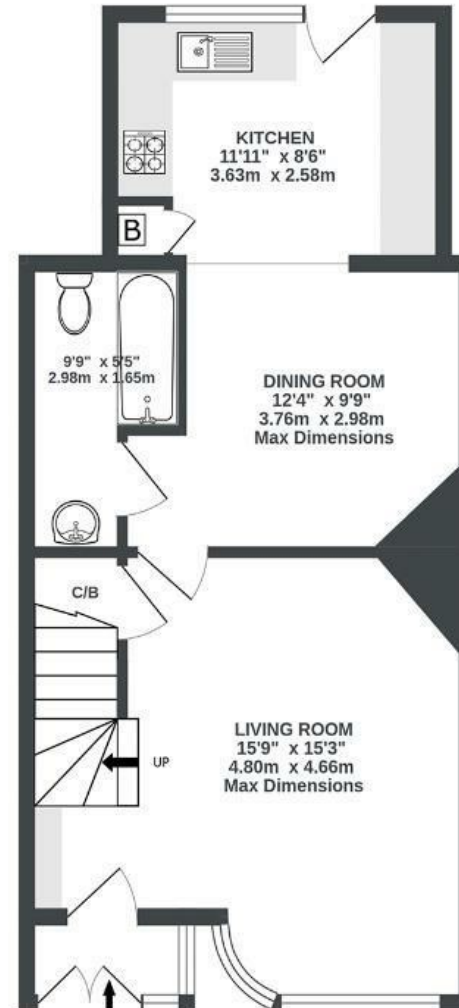

1ST FLOOR
348 sq.ft. (32.3 sq.m.) approx.

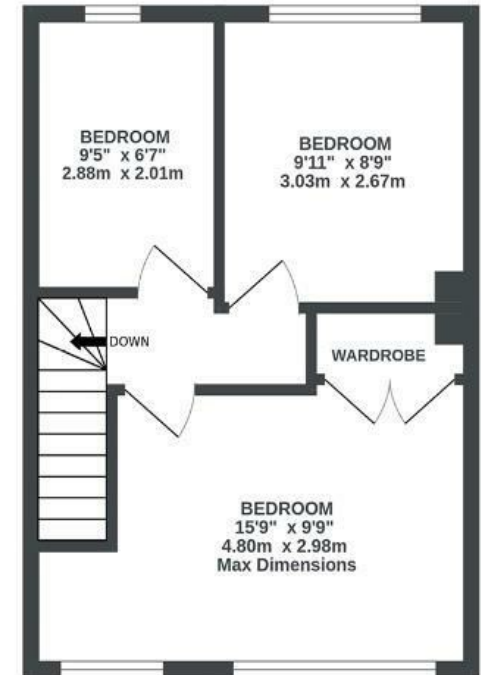

Illustrations are for reference purposes only, measurements are approximate, not to scale.

Boardwalk

Silbury Road

ASHTON VALE, BRISTOL



£350,000



BS3 2QD



3 Bedrooms



1 Bathrooms

"When we first walked into this house, we were struck by how light and airy the space was. It has been the perfect home for our expanding family. We have happy memories of lazing in the sunny garden watching the hot air balloons rising from nearby Ashton Court. Ashton Vale is a fantastic place to live: amazing people and lots of green spaces. It has the perfect balance of being peaceful with very easy access to the centre."

